

LPI-02 display is an integral element of temperature sensor, available also as a separate component. It enables local indication of temperature measured directly in connection head. It has 3 configuration keys at the front panel.

Specification

Characteristic

- for temperature sensors with connection head type DANAWwin
- 4-digit LED display, height 9,5 mm
- display screen size: 30x14 mm
- programmable via keypad
- set parameters: zero, span, decimal point
- Ingress Protection Rating of a housing IP20
- degree displaying: C°, F°, K, %, 4s values, 2s degrees
- cooperation with HART Communication Protocol

Input/output signal

4÷20 mA

Power supply

10÷30V DC

Range of programming / displaying

-1999÷9999

Voltage drop

3,3V at 4 mA; 3,7V at 20 mA

Set points

zero 4 mA
span 20 mA

Accuracy

0,1% range and +/- 1 digit

Temperature drift

20 ppm/°C for temperature 20°C

Electrical connection

2-wire <1 mm²

Dimensions [mm]

ø64 x 19

Operating conditions

ambient temperature: -20÷80°C
humidity: 25 to 95% RH non-condensing
storage temperature: -30÷80°C

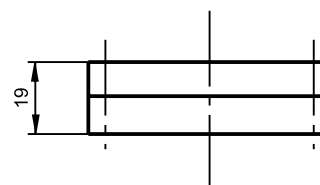
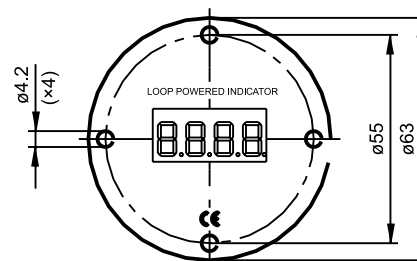
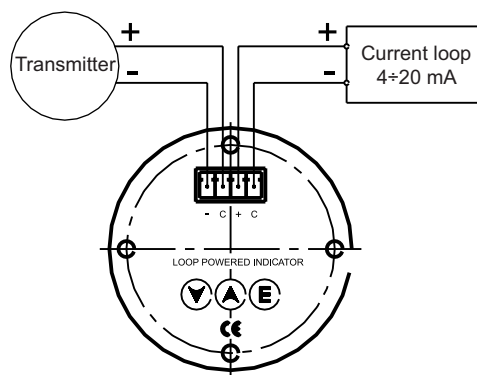

Product code

Temperature range	
(0÷100)°C	(0÷100)°C
1	other parameters acc. to requirements

LPI-01 –

Ordering example: **Digital display LPI-01–(0 ÷100)°C**