

OTG protection tube is a part of measuring installation, where a sensing element (temperature sensor) is installed by means of a threaded connector. Protection tube is mounted by means of flange. It is manufactured in accordance with individual client requirements.

## Specification

### Material\*

stainless steel 1.4541

### Dimensions\*

d x g	D
8 x 0,6	M12 x 1(1,5) G $\frac{1}{4}$
9 x 1	M14 x 1,5
10 x 1,5	M16 x 1,6
11 x 2	G $\frac{3}{8}$
12 x 1,5	M18 x 1,5
14 x 2	M20 x 1,5
15 x 2	G $\frac{1}{2}$ $\frac{1}{2}$ NPT

Other flange dimensions acc. to requirements

Protection tube length  $L_0$  [mm] = 50÷2000

\*Other parameters acc. to requirements

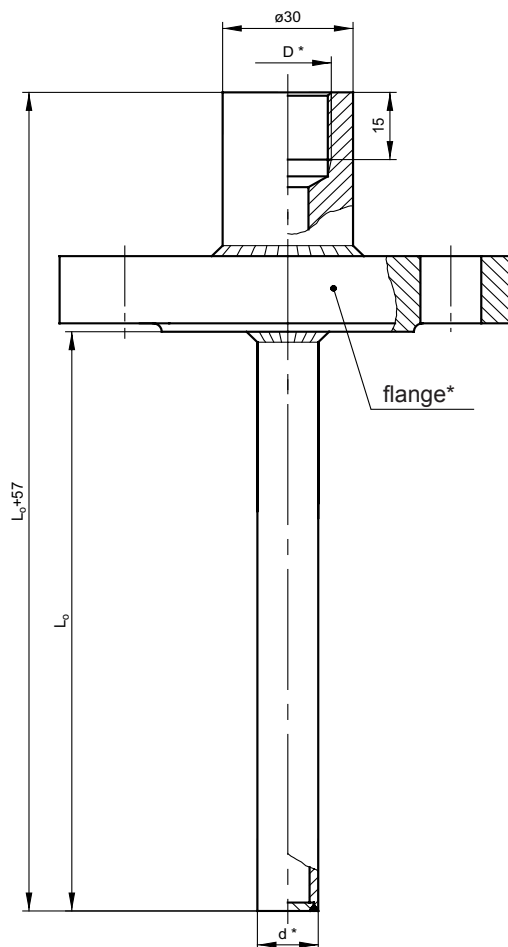

## Product code

		<b>Tube dimension d</b>	
1	<input type="text"/>	<b>10</b>	10mm
			other parameters acc. to requirements
		<b>Flange dimension</b>	
2	<input type="text"/>	<b>DN20PN16</b>	DN20PN16
			other parameters acc. to requirements
		<b>Thread dimension D</b>	
3	<input type="text"/>	<b>M18x1,5</b>	G $\frac{1}{4}$
			other parameters acc. to requirements
		<b>Protection tube length <math>L_0</math></b>	
4	<input type="text"/>	<b>300</b>	300mm
			other parameters acc. to requirements

1    2    3    4

OTG -  -  -  -

Ordering example:

**Protection Tube OTG-10x1,5-DN25PN40B1-G1/2-200**

### Note:

For matching thermowell with sensor length L,  $L_0 = L - 55$